



January 26, 2024

TO WHOM IT MAY CONCERN:

The Energy & Environment Division and the Real Property Services Division of the City of Aurora (City) have adopted the following revised procedures for leasing City-owned oil and gas minerals to ensure efficient and fair leasing. An application to lease City-owned minerals and all criteria detailed in the "Instructions" must be strictly adhered to. Any applications not conforming to the procedures detailed in the attached "Instructions" will be rejected.

Upon receipt of an unsolicited application to lease City-owned minerals, the Energy & Environment Division will request applications from competing companies. Applicants will be provided thirty (30) days from the date that bids are requested by the City. Instructions for submitting a bid and recommended minimum terms acceptable to the City are provided below.

The Energy & Environment Division Manager ("Manager") will review all applications and recommend terms from the highest and best application for City approval.

RECOMMENDATION FOR APPROVAL OF APPLICATION TERMS IS NOT A GUARANTEE, WHETHER IMPLIED OR EXPRESSED, OF ACCEPTANCE BY THE CITY OF ANY APPLICATION TO LEASE CITY-OWNED MINERALS. THE CITY RESERVES THE RIGHT TO REJECT ANY AND ALL APPLICATIONS OR TO ACCEPT ANY OTHER APPLICATION OR OFFER DEEMED APPROPRIATE AT THE SOLE DISCRETION OF THE CITY. ALL APPLICATIONS MUST COMPLY WITH THE TERMS IDENTIFIED IN THE ATTACHED "INSTRUCTIONS." FAILURE TO ADHERE WILL RESULT IN THE REJECTION OF YOUR APPLICATION.

Your attention to these matters is greatly appreciated. Should you have additional questions, please contact me at 303.739.7676 or by email at jmoore@auroragov.org.

Sincerely,

Jeffrey S. Moore, P.G.
Manager
Energy & Environment Division



CITY OF AURORA
ENERGY & ENVIRONMENT DIVISION
INSTRUCTIONS FOR LEASING CITY-OWNED MINERALS

In order to process an application for leasing City-owned minerals, the following items must be submitted to City of Aurora, Attn: Energy & Environment Division, 15151 E Alameda Parkway, 5th Floor, Aurora, CO 80012 or via email to oil&gas@auroragov.org, jmoore@auroragov.org, and hreynoso@auroragov.org. These instructions may also be found on our website: <https://www.auroragov.org/oilandgas>.

The following procedures will govern:

1. Company submits a completed Application To Lease City-Owned Minerals form (attached).
 - a. The City requires the initial lease term shall be for three (3) years, unless held by production with a twenty percent (20%) royalty interest.
 - b. The City recommends a minimum lease bonus of \$2,000 per net mineral acre.
2. City will request applications from competing companies.
 - a. Invitations to apply will be made via email to interested firms and/or be made available at the City of Aurora's Energy & Environment Division website: <https://www.auroragov.org/oilandgas>
 - b. Applicants will be allowed thirty (30) days to submit from the date City first requests applications.
 - c. The City of Aurora or its agents, representatives, or employees is not liable for any inconvenience or loss caused by errors in this listing that may occur.
3. Please send a courtesy email to let us know if you intend to submit an application to oil&gas@auroragov.org, jmoore@auroragov.org, and hreynoso@auroragov.org. The deadline set by the City still applies regardless of whether we receive a courtesy email of intent.
4. All offers must be accompanied with the summary page, detailing the City's percentage of ownership interest, of a Mineral Estate Ownership Report prepared by a licensed title examiner of an independent title company which is licensed through the Colorado Title Insurance Commission.
5. Where there is a conflict concerning the ownership of the lease, the owner of the lease shall provide evidence of ownership.
6. The City of Aurora Energy & Environment Manager ("Manager") will review all applications and recommend the highest and best terms for City Council approval.
 - a. A commitment by the Manager to recommend terms does NOT constitute acceptance of any application by the City.
 - b. The City reserves the right to reject any or all applications, to waive any informalities in applications, and to accept the application that, in the opinion of the City, is to the best interests of the City, its citizens, agents, employees, and representatives.
7. The City will notify all applicants of the winning bid. At that time, the winning applicant will have fifteen (15) days to provide the following additional documents:



- a. The City of Aurora, Colorado, "Paid-up Oil, Gas & Mineral Lease" ("Lease") must be used, and a blank copy will be provided to the winning applicant. Please note the Lease contains a signature line that must be signed and notarized by the Lessee or its authorized representative.
- b. Provide name and address of Lessee in the introductory paragraph of the Lease.
- c. Complete Paragraph #1 titled "Description" by writing the dollar amount for the up-front bonus payment on a per net mineral acre basis.
- d. Sign as Lessee and have notarized.
- e. Certified checks or cashier's check for the up-front bonus amount of bid must accompany the physical lease. Other forms of security will not be accepted.

THE CITY RESERVES THE RIGHT TO REJECT ANY AND ALL APPLICATIONS OR TO ACCEPT ANY OTHER APPLICATION OR OFFER DEEMED APPROPRIATE AT THE SOLE DISCRETION OF THE CITY. ALL APPLICATIONS MUST COMPLY WITH THE TERMS IDENTIFIED IN THE ATTACHED "INSTRUCTIONS." FAILURE TO ADHERE WILL RESULT IN THE REJECTION OF YOUR APPLICATION.

For further information, contact the Energy & Environment Division Manager at (303) 739-7676 or via email at jmoore@auroragov.org. You may also contact the Real Property Services Division Manager at (303) 739-7300 or via email at hreynoso@auroragov.org



15151 E. Alameda Parkway, Ste. 5900
Aurora, Colorado 80012
303.739.7010

Worth Discovering • AuroraGov.org

APPLICATION TO LEASE CITY-OWNED MINERALS

****EMAIL TO ADDRESS IN INSTRUCTIONS OR MAIL TO ADDRESS LISTED ABOVE****

Date:

Firm:

By:

Business:

Address:

Telephone:

E-Mail:

Signature

Please identify the property you are applying for below, then return your form to the Energy & Environment Division per the instructions.

	DESCRIPTION OF LAND	SECTION	TOWNSHIP	RANGE	ACRES	NMA	PRICE OFFERED PER NMA	ROYALTY %
0	That portion of the NE/4NE/4 of Section 30, T3S, R65W, 6th P.M., more particularly described by metes and bounds in that Special Warranty Deed, dated December 1, 2005, recorded at Reception No. 2006000055890 on January 17, 2006.	30	3S	65W	2.193	2.059	\$	%
1							\$	%
2							\$	%
3							\$	%

The city reserves the right to reject any and all applications or to accept any other application or offer deemed appropriate at the sole discretion of the city. All applications must comply with the terms identified in the attached "instructions." Failure to adhere will result in the rejection of your application.

For city use only: application request no.

EXHIBIT A: PROPOSED LEASE MAP



Section 19



Section 20

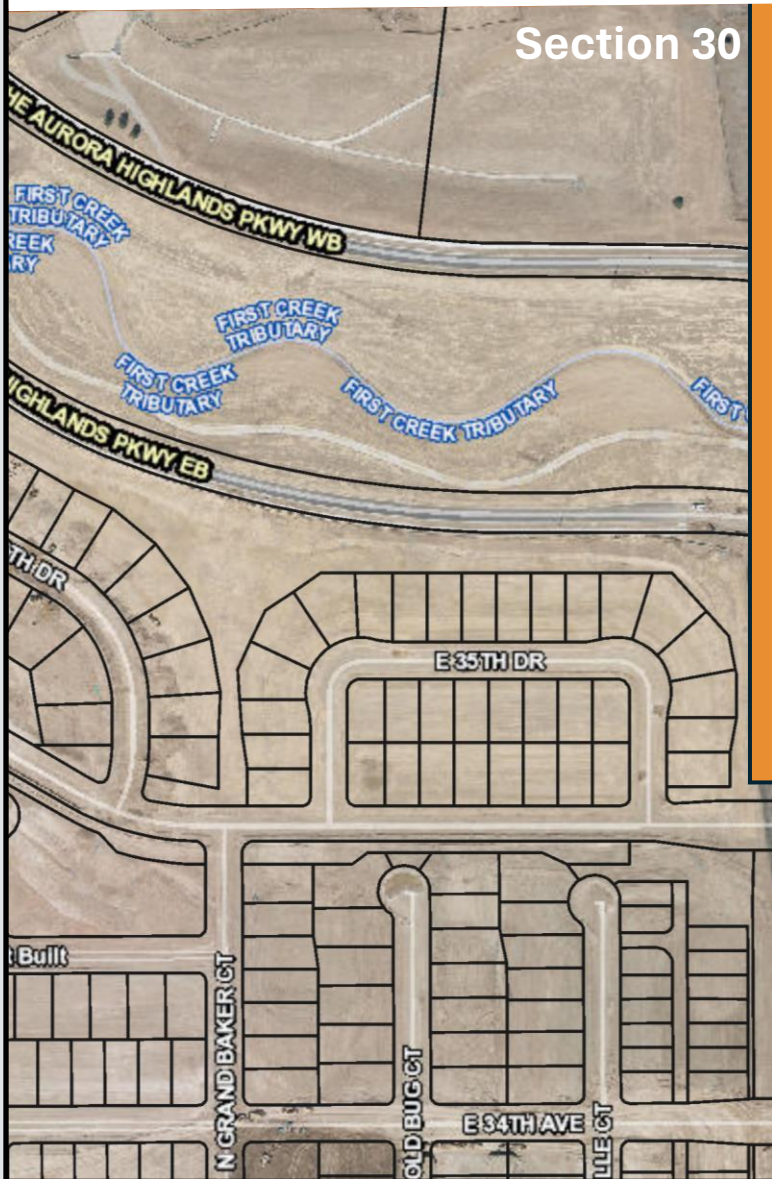

Section 30



Section 29



Township: 3S
Range: 65W
Section: 30 NE/4



This map is a graphic representation
and is only to be used as a visual aid.

 City parcel for lease